

BD Insyte Autoguard™

Shielded IV Catheters



POINTS TO PRACTICE

1 PREPARATION

- Make sure all items are accessible throughout the procedure
- Prepare site according to your facility's policy and procedure
- Prior to venipuncture hold catheter hub and **rotate barrel 360 degrees**
- Make sure catheter is seated back in the notch

2 VENIPUNCTURE

- Approach vein slowly at a low angle
- Observe early flashback along the catheter (20, 22, 24 gauge only)
In larger gauge sizes observe flash behind white button

3 ADVANCEMENT

- Upon flashback visualization, lower catheter almost parallel to the skin
- Advance *entire unit* slightly before threading catheter
- Thread catheter into vein while maintaining skin traction

4 NEEDLE REMOVAL

Before Pressing the Button

- Release tourniquet
- Apply digital pressure beyond the catheter tip
- Gently stabilize catheter hub
- Press the white button

5 SECUREMENT

- Secure catheter and apply sterile dressing according to your facility's policy and procedure

CAUTION REMINDERS

- **Do Not** withdraw needle from catheter hub before pressing the white button.
- **Needle should be retracted prior to disposal** in a puncture-resistant, leak-proof sharps container.
- **Never Reinsert Needle** into the catheter as this could shear the catheter.
- **Do Not Use Scissors** at or near the insertion site.

Refer to package insert for complete instructions for use.

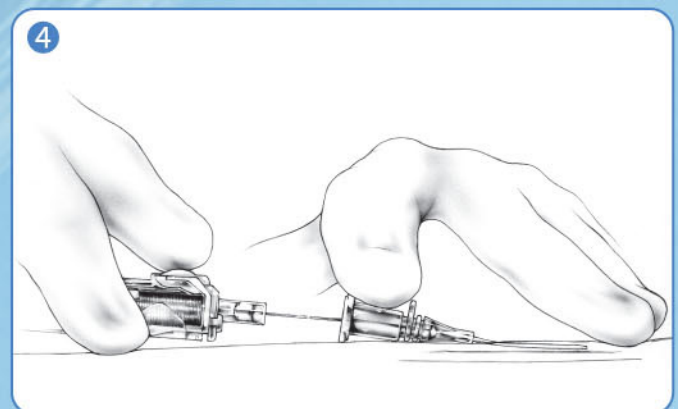
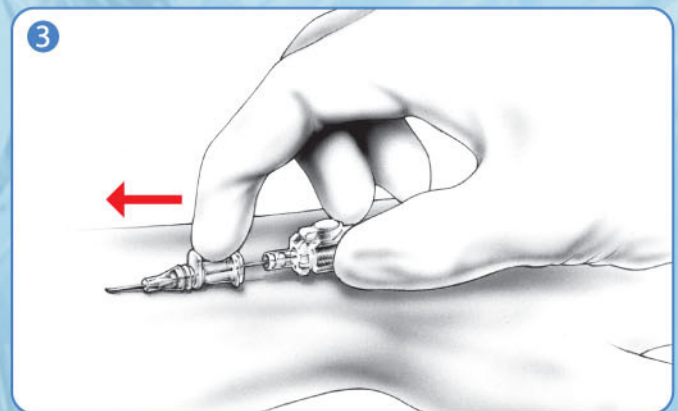
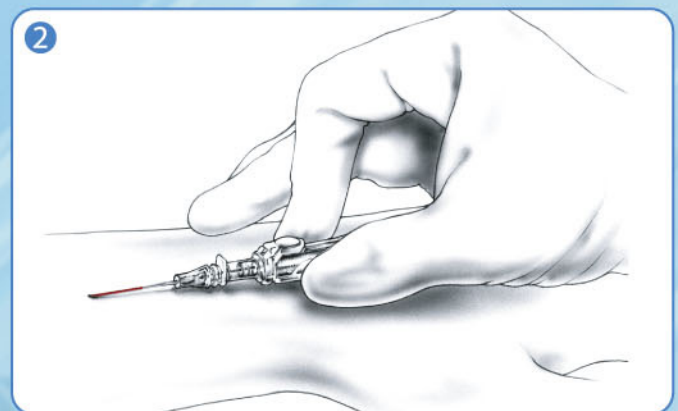
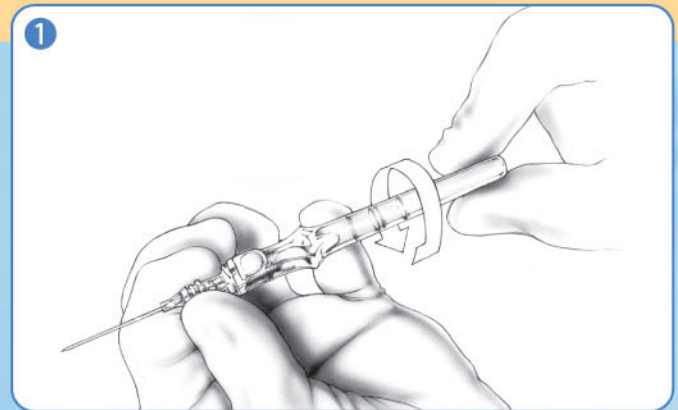

BD Insyte™ Autoguard™

Shielded IV Catheters

TIPS FOR SUCCESS

INSERTION SUCCESS

- Make sure tip seal is released before insertion, by **rotating the barrel 360°**
- Make sure catheter is seated back in the notch
- Slow down the speed of insertion
- Use less force to penetrate the skin
- Lower the initial insertion angle keeping the elbow low
- After flash, lower the angle and advance 1/8 inch

SEEING THE FLASH

- Trust your instinct and take a pause
- Look for the flash along the catheter
- Be aware of patient factors such as small veins, small patient, blood pressure, condition of vein, dehydration, etc., that may impact flash

THREADING WITH EASE

- After flash, lower the angle and advance 1/8 inch
- Avoid the push-pull technique when advancing
- Make sure tip seal is released before insertion, by **rotating the barrel 360°**
- Maintain traction on the skin

RETRACTING THE NEEDLE

- Make sure tip seal is released before insertion, by **rotating the barrel 360°**
- Make sure to place digital pressure **beyond** the tip of the catheter
- Make sure needle is not being inadvertently bent while attempting to activate the button

MINIMIZING THE BLOOD

- Release tourniquet *before* pressing the button
- Place digital pressure **beyond** the catheter tip
- Have IV connector or tubing close by and ready

AVOID EARLY ACTIVATION

- Be aware of where your fingers are
- Remove needle cover in a straight, outward motion

